

Protecta FR Acrylic - Concrete Wall Metal Pipe - Continuous Insulation Max Aperture 300x300mm or 504mm diam

Installation Instructions

1. Before installing Protecta® FR Acrylic ensure that the surface of all service penetrations and surrounding construction is free from all loose contaminants, dust and grease.
2. Where Protecta® FR Acrylic is to be installed against surfaces that cannot tolerate direct contact; appropriate surface preparation should be made (contact Polyseam for guidance in these cases). For paints sensitive to sealing compounds, priming with a PVA primer is recommended.
3. When installing any backing material, cut this slightly oversize and insert into the gap ensuring a tight friction fit. Ensure correct depth is achieved.
4. Fill the gap or joint with Protecta® FR Acrylic to the required depth.
5. Apply the sealant generously to prevent air bubbles. Finish the bead with a moist spatula, pallet knife or brush.
6. Protecta® FR Acrylic can be over-painted with most emulsion or alkyd (gloss) paints.

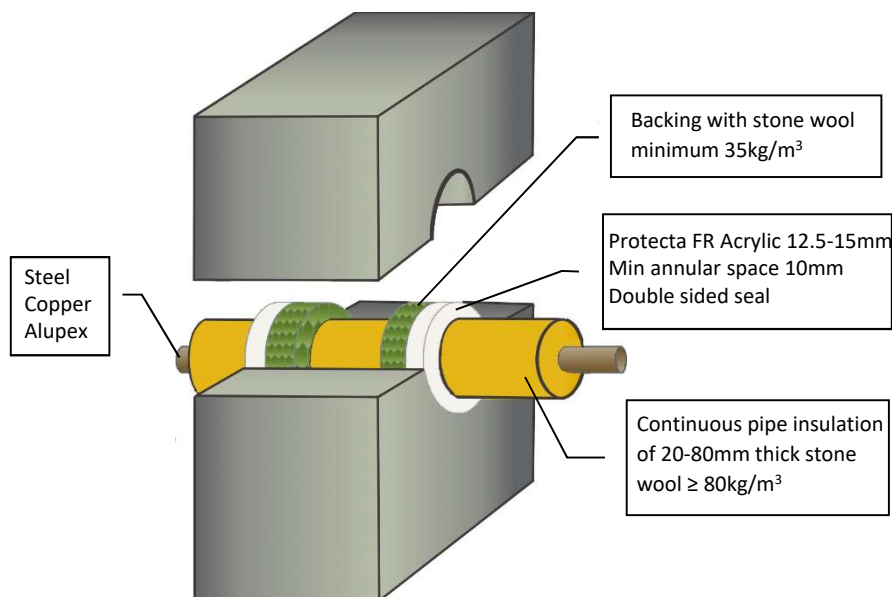

System/FPA Register ID# FC279

Products	Protecta FR Acrylic Stone wool
Application	Fire stopping of steel pipes in rigid walls
Construction	Minimum wall thickness of 100 mm and comprise concrete, aerated concrete or masonry, with a density of $\geq 650 \text{ kg/m}^3$

Fire & Sound classification

In 150mm walls:	
Steel pipes $\leq \text{Ø}324\text{mm}$ with 15mm Acrylic, 25mm backing and 30-80mm thick pipe insulation	FRR -/240/240
In 100mm walls:	
Steel pipes $\leq \text{Ø}324\text{mm}$ with 12.5mm Acrylic, 12.5mm backing and 30-80mm thick pipe insulation	FRR -/120/90
Copper pipes $\leq \text{Ø}54\text{mm}$ with 12.5mm Acrylic, 12.5mm backing and 20-80mm thick pipe insulation	FRR -/120/60
Alupex pipes $\leq \text{Ø}75\text{mm}$ with 12.5mm Acrylic, 12.5mm backing and 20-50mm thick pipe insulation	FRR -/120/120

Zero smoke leakage up to 200Pa

Sound reduction (seal only) STC 62

As a part of our policy of on-going product development and testing, we reserve the right to modify, alter or change product specifications without giving notice. All information contained in this document is given in good faith and is provided for guidance only. Any drawings provided are for illustrative purposes only. As Polyseam has no control over the methods or competence of installation and of prevailing site conditions, no warranties, expressed or implied, is intended to be given as to the actual performance of the product mentioned or referred to herein and no liability whatsoever will be accepted for any loss, damage or injury arising from the use of the information given.

For all technical details on the products specified please refer to the technical data sheets that can be found on www.firestopcentre.co.nz

Signed and approved:



Sheet size: A4	Drawn date & no: 24/5/21
--------------------------	-----------------------------

Scale: NTS	Drawn by: K.B
----------------------	------------------